

**grinding spindle:
special**

24.000 min⁻¹

specification

1.2.2021

interface:	special
tool release unit:	none
rotation unit:	no
encoder:	no
max. speed:	24000 min ⁻¹
nominal speed:	15000 min ⁻¹
nominal power:	43 kW
nominal torque:	27,4 Nm
kind of motor:	asynchronous
spindle housing design:	quill
installation diameter:	170 mm
total length:	464 mm
working position:	horizontal
bearing Lubrication:	oil air

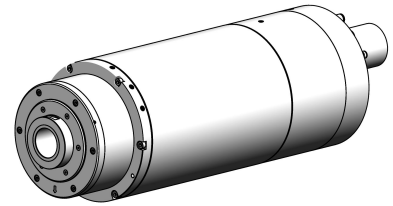

WEISS
G M B H