

milling spindle:  
HSK-E1560.000 min<sup>-1</sup>

## specification

29.8.2023

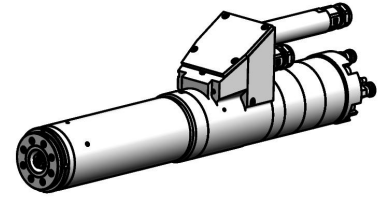

interface:	HSK-E15
cleaning air:	1 channel
tool release unit:	WEISS/PNEU
rotation unit:	none
encoder:	SENSITEC
increment number:	64
max. speed:	60000 min <sup>-1</sup>
nominal speed:	80000 min <sup>-1</sup>
nominal power:	0,6 kW
nominal torque:	0,1 Nm
kind of motor:	synchronous
moment of inertia (spindle):	0,0000 kgm <sup>2</sup>
spindle housing design:	quill
installation diameter:	32 mm
total length:	209 mm
working position:	horizontal
front bearing:	
ISO Size Code:	18
bearing bore diameter:	17 mm
bearing pitch circle diameter:	21,5 mm
character speed value:	1,29 Mio dn
rear bearing:	
ISO Size Code:	18
bearing bore diameter:	15 mm
Arrangement of bearings:	<< M ~>>
bearing Lubrication:	grease

**WEISS**  
G M B H